



# Hampton



RAINIER TENT

**East Coast**

8675 Florida Mining Blvd, Tampa, FL 33634  
(425) 981-1265

**West Coast**

18375 Olympic Avenue South, Tukwila, WA 98188  
(425)-981-1233

Visit Our Website: [RainierTent.com](https://www.RainierTent.com)

SIMPLICITY · PERFORMANCE · STYLE



# Create an unforgettable atmosphere...

Baytex Hampton pole tent has the elegance of a traditional pole marquee teamed with the optimum performance of a fully engineered tensile membrane. These beautiful marquees are fully engineered and manufactured for optimum performance in challenging weather conditions. Very quiet and stable in windy conditions.

For ease of use and adaptability this tent can be used as a

- One pole 32' x 30' (9.7m x 9.7m)
- Two pole / Low Mid only 32' x 50' (9.7m x 15.7m – 6m mid-section)
- Three pole 32' x 70' (9.7m x 21.2m – (x2) 6m mid-sections).

Add and remove sections as the event requires, you can even add extra length to the tent by adding poles and mid sections accordingly.

The Hampton is sold in high quality Serge Ferrari F402 Champagne or F502 White PVC. Ferrari is a world renowned European brand. The fabric is fire-rated and backed by a five year manufacturer's warranty & is very easy to keep clean providing you adhere to the care and maintenance guides.

The roof laces up in sections with a velcro weather flap for ease off storage & cleaning.

The side and center poles are all tempered aluminium coated with our proprietary finish to give a realistic wooden look. Standard Leg height 7'.



...clean lines and stunning design.

## Gallery





# Gallery

9.7mx9.2m



9.7mx15.2m Low Mid



9.7mx21.2m Low Mid



## Fabric

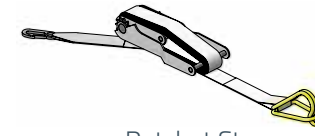

Ratchet Straps  
with PVC cover

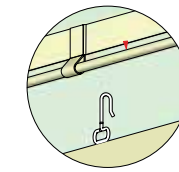

**Fitted Walling 10' Walls**  
hooks onto interior cord & wall bar pockets  
• plain • clear  
+ 1 bag for 4 walls

## Hardware

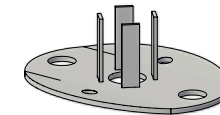

Base Foot

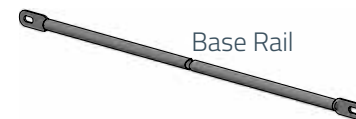

Base Rail



Tent Stakes

### HAMPTON

• 32'  
20' Bays  
F402 Champagne or  
F502 White

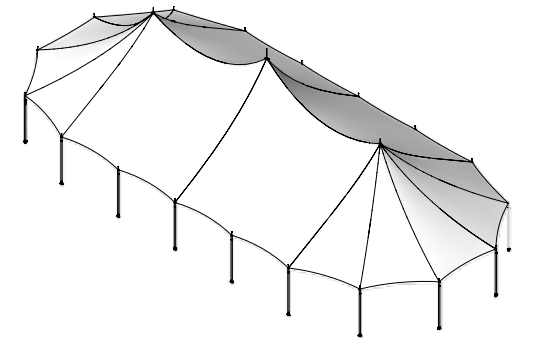

All Hamptons are supplied with PVC roof, ratchets, plain PVC walling, roof bags, wall bags, poles, stillage, pegs



plain

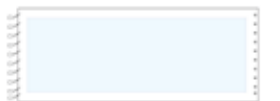

clear

**Hampton - Serge Ferrari PVC**  
Is a top quality PVC from France.  
Fire Rated (certification available)

### Hampton Poles Timber Coated Alloy

Center Poles (timber coated)  
Wall Poles (timber coated)  
Base Rails (steel)

The **Hampton** has alloy center and side poles that are coated to give a realistic timber finish.

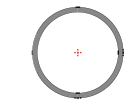

Tube ø 2"  
corner & side poles



Tube ø 3"  
Low Mid center poles



Tube ø 4"  
High Mid center poles

### Storage Stillage

### Stakes

2 stakes per foot:  
2 guys up to 70kph  
For over 70kph take  
down.

Recommendations only, based  
on firm soil types

### Product Information:

Product Information:  
[RainierTent.com/structures/hampton/](http://RainierTent.com/structures/hampton/)

**Engineering Reports (PS1s)**  
available

**Fire Retardant Reports**  
available

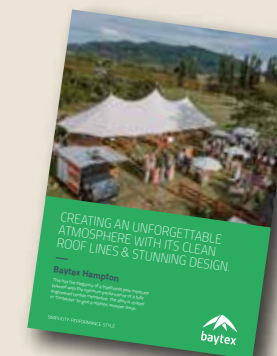

Cast Pole

Anodized alloy rail components for light weight strength and durability. High quality electro galvanized steel connectors ensure long lasting, clean appearance.



# Fabric

The Hampton is sold in Ferrari F402 Champagne or F502 White with a varnish both sides for a smooth, glossy, dirt resistant finish. The beautiful shaping and detailed design of the roof sets the Hampton apart. Fire retardant fabric. High frequency welded for optimum strength, fabricated in NZ.



# Timber Tec

Alloy center and side poles are coated in an alloy finish to give a realistic timber finish.

## Our Process

We use a photo imaging process that involves a physical reaction between special inks and the base coating. Under controlled conditions of 'heat and pressure' photographic images are fused directly into the special base coating. The image carries a wood look which is transferred into the powder coated surface, then the film is removed and disposed of. The process is called sublimation. The finished product is as robust as standard powder coating, you couldn't chip the wood look without removing the powder coating as well.

There are many options of woodgrain, most choose to go with Black Wattle or Rimu.

# Add ons



Our Hampton Drape is made out of our champagne Silkline fabric with a soft drape to the 75d fabric. It comes with ties and 'puddles' at the bottom. Fire rated fabric.



Impress your customers with this feature entryway, style to add impact.

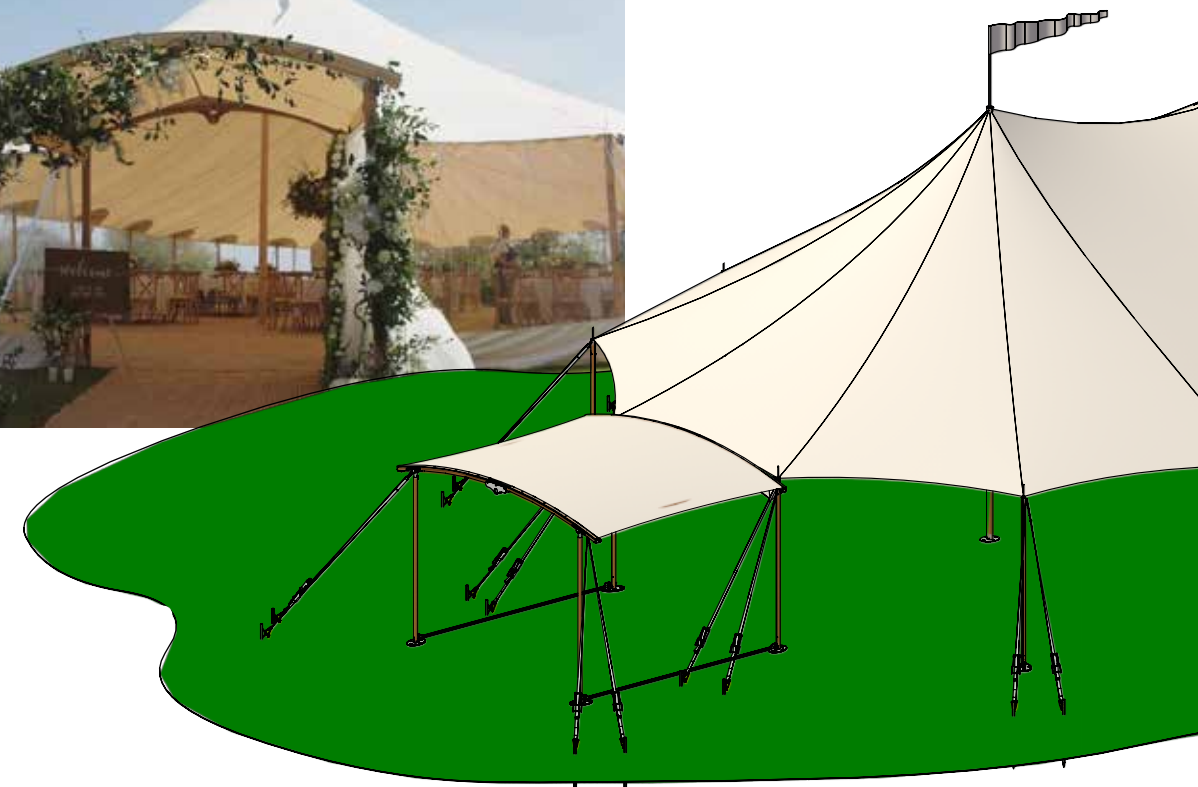



## Add ons



All of our Hampton's come with 6' Flags, but you can stand out with your full colour sublimated logo for a small additional cost. Even put your Bride & Grooms names on.

Add clear mids for a point of difference

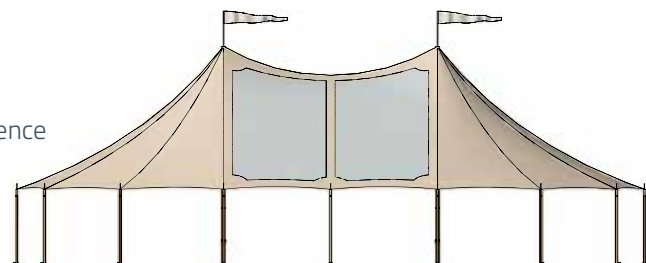

If you aren't using walls hang a Hampton Valance instead, team up with our Hampton Wall Drapes for full glamour.



20' x 17' stand alone tent or use the 10' side against your Hampton as an entryway, gutter can be purchased.

## Stillage and PVC Cover

To help protect the poles while storing and transporting they are nested on plywood profiles with protective padding in a purpose built steel stillage with a heavy duty PVC cover. All roofs and walls are supplied in PVC bags - let us know if you would like your logo on these for no additional charge.

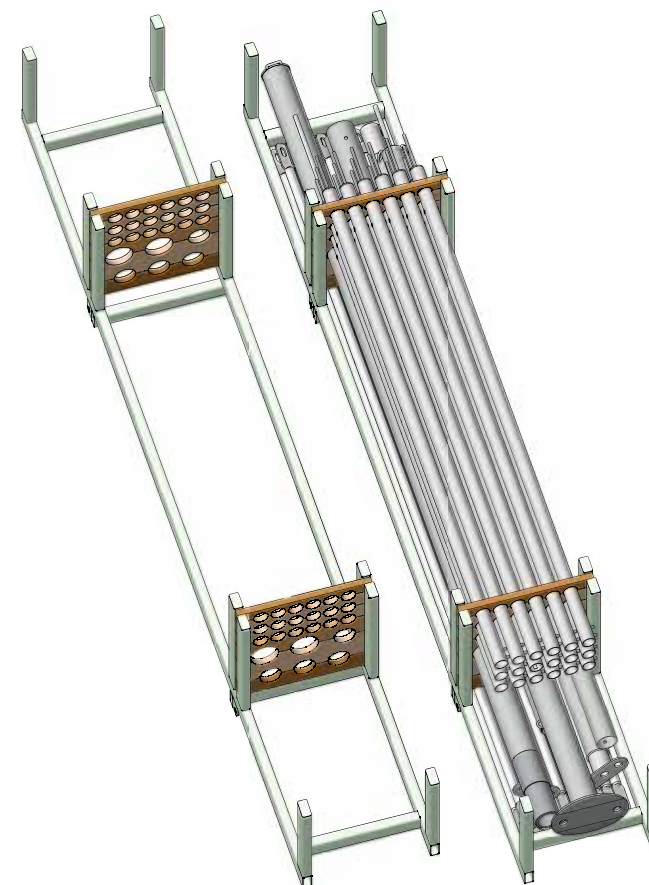

## Groundsheets

Designed to protect your Hampton while setting up. Made in sections out of blue/silver Polyethylene and eyeleted around the sides.



HAMPTON LOW MIDS

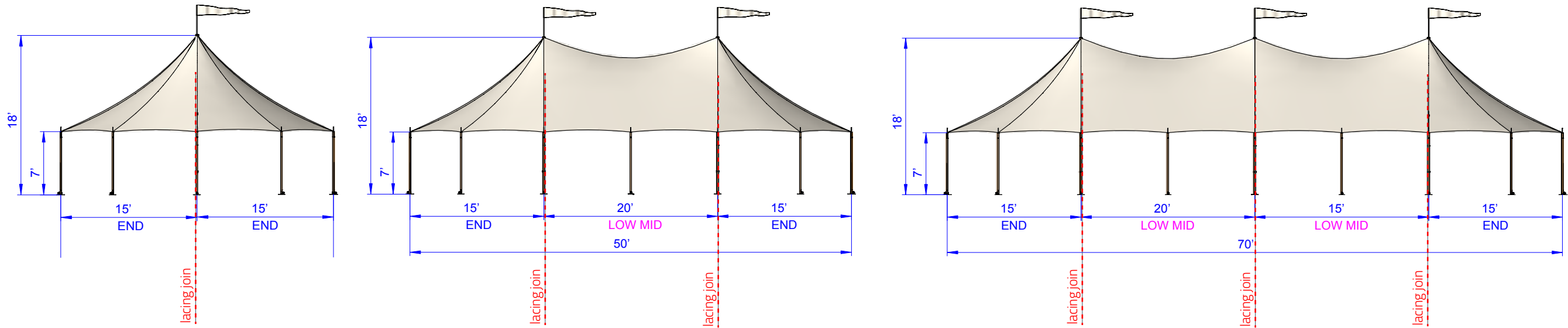

keep adding low mids

Size and Style Options

HAMPTON HIGH MIDS

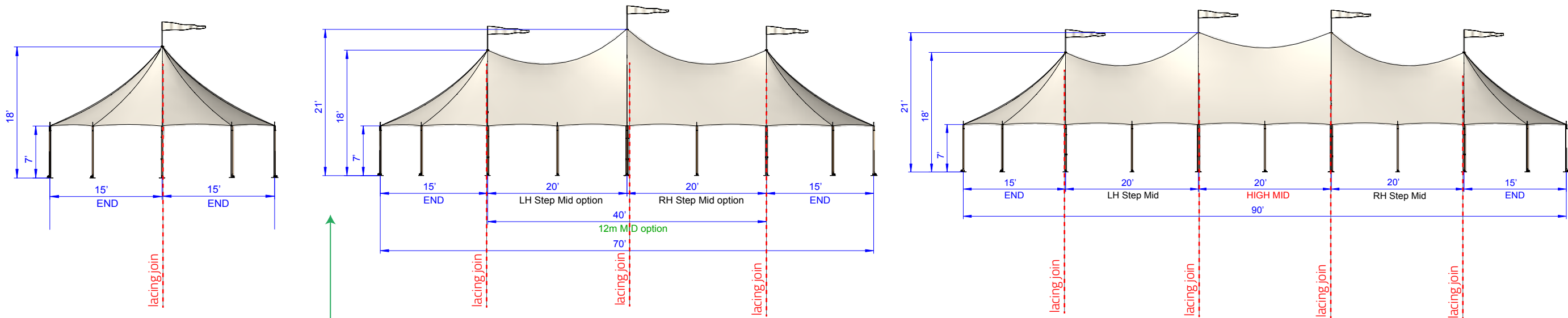

keep adding high mids

Note: unable to build a 50' long with the High Mid option

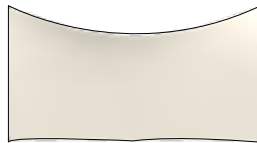

OR additionally purchase a 6m low mid (PVC only) and use your existing high-mid hardware to create the 50' long Hampton